

# HDPE 100

## PE FITTINGS

POLYETHYLENE  
DISPLAYS GOOD  
**CHEMICAL**  
RESISTANCE MATERIAL  
**STRENGTH AND RIGIDITY**  
WITHIN A TEMPERATURE  
RANGE OF.  
40° C AND + 80° C.





## GENERAL PRODUCT SPECIFICATION

Alongside its outstanding processability, polyethylene (PE) displays good chemical resistance and offers strength and rigidity within a temperature range of between - 40 °C and + 80 °C. Due to the inclusion of soot particles, PE is resistant to UV light and therefore also suitable for long-term outdoor applications.

The recent development in the family of PE on the basis of PE 100 is PE 100 RC (resistant to crack) with an improved characteristic against slow crack propagation.

The electrically conductive material PE-EL dissipates static charges and prevents sparking.



## ADVANTAGES OF PE 100 FITTINGS

- Versatility of use.
- Very good chemical and corrosion resistance.
- Proven physiological harmlessness and therefore suitable for contact with food.
- No influence on drinking water quality.
- Biologically inert; no support of microbial growth.
- High mechanical tensile strength.
- Secure solvent cementing using Tangit.
- Use of tin stabilizers for fittings and valves.

## UV AND WEATHER RESISTANCE

PE 100 is very weather-resistant. Even longer exposure to direct sunlight, wind and rain does hardly any damage to the material. Despite its very good weather resistance to ultraviolet radiation, PE 100 loses some of its impact strength. In extreme applications, it can be advantageous to protect the material from direct sunlight exposure. Contact your HYDROPLAST representative for suitable protective measures.



## PE 100 PROPERTIES

| Material specifications                      | Test Method                      | Value                  | Unit of Measurement |
|--|----------------------------------|------------------------|---------------------|
| Density,                                     | ISO 1183                         | 0.960                  | g/cm <sup>3</sup>   |
| Yield stress                                 | DIN EN ISO 527                   | 23                     | MPa                 |
| Elongation at yied                           | DIN EN ISO 527                   | 9                      | %                   |
| Elongation at break                          | DIN EN ISO 527                   | 600                    | %                   |
| Tensile modulus of elasticity                | DIN EN ISO 527                   | 1100                   | MPa                 |
| Impact strength                              | DIN EN ISO 179                   | no break               | kJ/m <sup>2</sup>   |
| Notched impact strength                      | DIN EN ISO 179                   | 30                     | kJ/m <sup>2</sup>   |
| Ball indentation hardness                    | DIN EN ISO 2039-1                | 40                     | MPa                 |
| Shore hardness                               | ISO 868                          | 65                     | D                   |
| Mean coefficient of linear thermal expansion | DIN 53752                        | 1.8 · 10 <sup>-4</sup> | K <sup>-1</sup>     |
| Thermal conductivity                         | DIN 52612                        | 0.38                   | W/m · K             |
| FNCT   | ISO 16770/PAS 1075               | > 300                  | Hours               |
| Surface resistance                           | DIN IEC 167                      | 1.10 <sup>14</sup>     | Ohm                 |
| Combustibility                               | DIN 4102                         | B2                     | -                   |
| Physiological acceptability                  | as per BfR                       | yes                    | -                   |
| Chemical resistance                          | according to DIN 8075 Supplement | fulfilled              | -                   |
| Temperature range                            | -                                | 40 to + 80             | °C                  |
| MRS  | ISO/TR 9082                      | 10                     | MPa                 |
| OIT  | EN 728                           | 30                     | min                 |

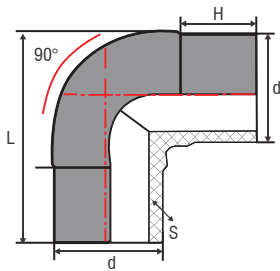
**PE 100**
**ELBOW 90°**
**SDR 17 - PN 10**

| PART #         | DIAMETER<br>Ød | L   | H   | S     |
|----------------|----------------|-----|-----|-------|
| 0329LE900200HP | 63             | 133 | 65  | 3.71  |
| 0329LE900250HP | 75             | 150 | 75  | 4.41  |
| 0329LE900300HP | 90             | 176 | 80  | 5.29  |
| 0329LE900400HP | 110            | 195 | 75  | 6.47  |
| 0329LE900400HP | 125            | 215 | 80  | 7.35  |
| 0329LE900500HP | 140            | 225 | 80  | 8.24  |
| 0329LE900600HP | 160            | 270 | 90  | 9.41  |
| 0329LE900700HP | 180            | 280 | 90  | 10.59 |
| 0329LE900800HP | 200            | 305 | 95  | 11.76 |
| 0329LE900900HP | 225            | 350 | 110 | 13.24 |
| 0329LE901000HP | 250            | 360 | 100 | 14.71 |
| 0329LE901100HP | 280            | 395 | 108 | 16.47 |
| 0329LE901200HP | 315            | 415 | 100 | 18.53 |
| 0329LE901400HP | 400            | 460 | 100 | 20.88 |
| 0329LE901600HP | 450            | 525 | 110 | 23.53 |
| 0329LE901800HP | 500            | 630 | 160 | 26.47 |
| 0329LE902000HP | 560            | 705 | 180 | 29.41 |
| 0329LE902200HP | 630            | 780 | 200 | 32.94 |
| 0329LE902400HP | 710            | 865 | 220 | 37.06 |
| 0329LE902800HP | 800            | 900 | 170 | 41.76 |

**PE 100**  
**ELBOW 90°**  
**SDR 11 - PN 16**

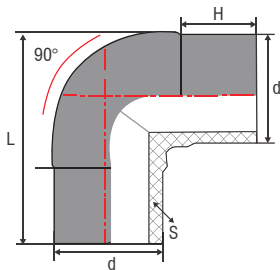

| PART #         | DIAMETER<br>Ød | L   | H   | S     |
|----------------|----------------|-----|-----|-------|
| 0329NE900200HP | 63             | 133 | 65  | 5.73  |
| 0329NE900250HP | 75             | 150 | 75  | 6.82  |
| 0329NE900300HP | 90             | 176 | 80  | 8.18  |
| 0329NE900400HP | 110            | 195 | 75  | 10.00 |
| 0329NE900500HP | 125            | 215 | 80  | 11.36 |
| 0329NE900600HP | 140            | 225 | 80  | 12.73 |
| 0329NE900700HP | 160            | 270 | 90  | 14.55 |
| 0329NE900800HP | 180            | 280 | 90  | 16.36 |
| 0329NE900900HP | 200            | 305 | 95  | 18.18 |
| 0329NE901000HP | 225            | 350 | 110 | 20.45 |
| 0329NE901100HP | 250            | 360 | 100 | 22.73 |
| 0329NE901200HP | 280            | 395 | 108 | 25.45 |
| 0329NE901400HP | 315            | 415 | 100 | 28.64 |
| 0329NE901600HP | 355            | 460 | 100 | 32.27 |
| 0329NE901800HP | 400            | 525 | 110 | 36.36 |
| 0329NE902000HP | 450            | 630 | 160 | 40.91 |
| 0329NE902200HP | 500            | 705 | 180 | 45.45 |
| 0329NE902400HP | 560            | 780 | 200 | 50.91 |
| 0329NE902800HP | 630            | 865 | 220 | 57.27 |

**PE 100**  
**ELBOW 45°**  
**SDR 17 - PN 10**

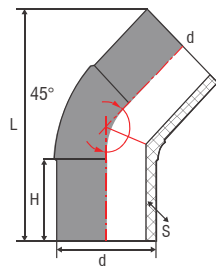

| PART #         | DIAMETER<br>Ød | L   | H   | S     |
|----------------|----------------|-----|-----|-------|
| 0329LE450200HP | 63             | 170 | 65  | 5.73  |
| 0329LE450250HP | 75             | 190 | 70  | 6.82  |
| 0329LE450300HP | 90             | 205 | 75  | 8.18  |
| 0329LE450400HP | 110            | 260 | 85  | 10.00 |
| 0329LE450400HP | 125            | 238 | 80  | 11.36 |
| 0329LE450500HP | 140            | 255 | 80  | 12.73 |
| 0329LE450600HP | 160            | 325 | 100 | 14.55 |
| 0329LE450700HP | 180            | 300 | 90  | 16.36 |
| 0329LE450800HP | 200            | 360 | 110 | 18.18 |
| 0329LE450900HP | 225            | 365 | 110 | 20.45 |
| 0329LE451000HP | 250            | 385 | 110 | 25.45 |
| 0329LE451100HP | 280            | 400 | 108 | 28.64 |
| 0329LE451200HP | 315            | 430 | 110 | 32.27 |
| 0329LE451400HP | 355            | 430 | 100 | 36.36 |
| 0329LE451600HP | 400            | 490 | 110 | 40.91 |
| 0329LE451800HP | 450            | 610 | 160 | 45.45 |
| 0329LE452000HP | 500            | 685 | 180 | 50.91 |
| 0329LE452200HP | 560            | 770 | 200 | 57.27 |
| 0329LE452400HP | 630            | 845 | 220 | 64.55 |
| 0329LE452800HP | 710            | 830 | 170 | 72.73 |
| 0329LE453400HP | 800            | 900 | 170 | -     |

**PE 100**  
**ELBOW 45°**  
**SDR 11 - PN 16**

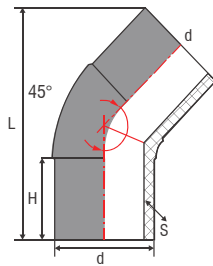

| PART #         | DIAMETER<br>Ød | L   | H   | S     |
|----------------|----------------|-----|-----|-------|
| 0329NE450200HP | 63             | 170 | 65  | 5.73  |
| 0329NE450250HP | 75             | 190 | 70  | 6.82  |
| 0329NE450300HP | 90             | 205 | 75  | 8.18  |
| 0329NE450400HP | 110            | 260 | 85  | 10.00 |
| 0329NE450400HP | 125            | 238 | 80  | 11.36 |
| 0329NE450500HP | 140            | 255 | 80  | 12.73 |
| 0329NE450600HP | 160            | 325 | 100 | 14.55 |
| 0329NE450700HP | 180            | 300 | 90  | 16.36 |
| 0329NE450800HP | 200            | 360 | 110 | 18.18 |
| 0329NE450900HP | 225            | 365 | 110 | 20.45 |
| 0329NE451000HP | 250            | 385 | 110 | 25.45 |
| 0329NE451100HP | 280            | 400 | 108 | 28.64 |
| 0329NE451200HP | 315            | 430 | 110 | 32.27 |
| 0329NE451400HP | 355            | 430 | 100 | 36.36 |
| 0329NE451600HP | 400            | 490 | 110 | 40.91 |
| 0329NE451800HP | 450            | 610 | 160 | 45.45 |
| 0329NE452000HP | 500            | 685 | 180 | 50.91 |
| 0329NE452200HP | 560            | 770 | 200 | 57.27 |
| 0329NE452400HP | 630            | 845 | 220 | 64.55 |
| 0329NE452800HP | 710            | 830 | 170 | 72.73 |
| 0329NE453400HP | 800            | 900 | 170 |       |

**PE 100**

# EQUAL TEE

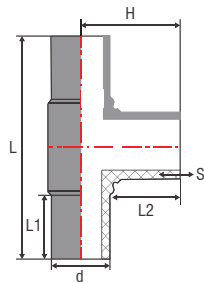
**SDR 17 - PN 10**

| PART #         | DIAMETER<br>Ød | L    | L1  | L2  | H   | S     |
|----------------|----------------|------|-----|-----|-----|-------|
| 0329LE900200HP | 63             | 182  | 58  | 56  | 90  | 3.71  |
| 0329LE900250HP | 75             | 232  | 70  | 70  | 117 | 4.41  |
| 0329LE900300HP | 90             | 240  | 70  | 70  | 120 | 5.29  |
| 0329LE900400HP | 110            | 265  | 70  | 70  | 133 | 6.47  |
| 0329LE900450HP | 125            | 305  | 80  | 80  | 150 | 7.35  |
| 0329LE900500HP | 140            | 320  | 80  | 80  | 160 | 8.24  |
| 0329LE900600HP | 160            | 348  | 85  | 85  | 176 | 9.41  |
| 0329LE900700HP | 180            | 400  | 90  | 90  | 197 | 10.59 |
| 0329LE900800HP | 200            | 420  | 95  | 95  | 205 | 11.76 |
| 0329LE900900HP | 225            | 485  | 90  | 110 | 242 | 13.24 |
| 0329LE901000HP | 250            | 430  | 110 | 95  | 230 | 14.71 |
| 0329LE901100HP | 280            | 535  | 90  | 95  | 275 | 16.47 |
| 0329LE901200HP | 315            | 500  | 90  | 95  | 302 | 18.53 |
| 0329LE901300HP | 355            | 565  | 100 | 100 | 302 | 20.88 |
| 0329LE901400HP | 400            | 655  | 112 | 112 | 330 | 23.53 |
| 0329LE901500HP | 450            | 750  | 135 | 150 | 405 | 26.47 |
| 0329LE901600HP | 500            | 800  | 135 | 170 | 455 | 29.41 |
| 0329LE901700HP | 560            | 910  | 140 | 170 | 475 | 32.94 |
| 0329LE901800HP | 630            | 970  | 150 | 160 | 485 | 37.06 |
| 0329LE901900HP | 710            | 1140 | 210 | 210 | 570 | 41.76 |
| 0329LE902000HP | 800            | 1260 | 230 | 230 | 630 | 47.06 |



## PE 100 EQUAL TEE SDR 11 - PN 16

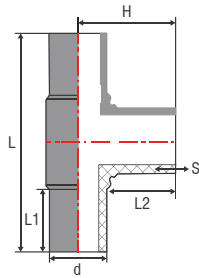

| PART #         | DIAMETER<br>Ød | L   | L1  | L2  | H   | S     |
|----------------|----------------|-----|-----|-----|-----|-------|
| 0329NE900200HP | 63             | 182 | 58  | 56  | 90  | 5.73  |
| 0329NE900250HP | 75             | 232 | 70  | 70  | 117 | 6.82  |
| 0329NE900300HP | 90             | 240 | 70  | 70  | 120 | 8.18  |
| 0329NE900400HP | 110            | 265 | 70  | 70  | 133 | 10.00 |
| 0329NE900450HP | 125            | 305 | 80  | 80  | 150 | 11.36 |
| 0329NE900500HP | 140            | 320 | 80  | 80  | 160 | 12.73 |
| 0329NE900600HP | 160            | 348 | 85  | 85  | 176 | 14.55 |
| 0329NE900700HP | 180            | 400 | 90  | 90  | 197 | 16.36 |
| 0329NE900800HP | 200            | 420 | 95  | 95  | 205 | 18.18 |
| 0329NE900900HP | 225            | 485 | 90  | 110 | 242 | 20.45 |
| 0329NE901000HP | 250            | 430 | 110 | 95  | 230 | 22.73 |
| 0329NE901100HP | 280            | 535 | 90  | 95  | 275 | 25.45 |
| 0329NE901200HP | 315            | 500 | 90  | 95  | 302 | 28.64 |
| 0329NE901300HP | 355            | 565 | 100 | 100 | 302 | 32.27 |
| 0329NE901400HP | 400            | 655 | 112 | 112 | 330 | 36.36 |
| 0329NE901500HP | 450            | 750 | 135 | 150 | 405 | 40.91 |
| 0329NE901600HP | 500            | 800 | 135 | 170 | 455 | 45.45 |
| 0329NE901700HP | 560            | 910 | 140 | 170 | 475 | 50.91 |
| 0329NE901800HP | 630            | 970 | 150 | 160 | 485 | 57.27 |

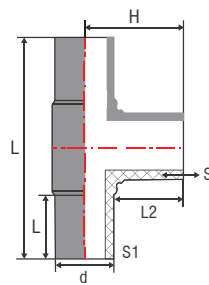
**PE 100**
**REDUCING TEE**
**SDR 17 - PN 10**

| PART #             | DIAMETER<br>Ød | L   | L1  | L2  | H   | S1    | S    |
|--------------------|----------------|-----|-----|-----|-----|-------|------|
| 0329LRTM02500150HP | 75-50          | 199 | 70  | 55  | 94  | 4.41  | 2.94 |
| 0329LRTM03000150HP | 90-50          | 243 | 80  | 65  | 115 | 5.29  | 2.94 |
| 0329LRTM03000200HP | 90-63          | 243 | 80  | 68  | 123 | 5.29  | 3.70 |
| 0329LRTM03000250HP | 90-75          | 270 | 80  | 75  | 130 | 5.29  | 4.41 |
| 0329LRTM04000150HP | 110-50         | 242 | 83  | 60  | 125 | 6.47  | 2.94 |
| 0329LRTM04000200HP | 110-63         | 242 | 83  | 62  | 130 | 6.47  | 3.70 |
| 0329LRTM04000250HP | 110-75         | 275 | 83  | 80  | 138 | 6.47  | 4.41 |
| 0329LRTM04000300HP | 110-90         | 275 | 83  | 82  | 140 | 6.47  | 5.29 |
| 0329LRTM04500300HP | 125-90         | 305 | 80  | 75  | 150 | 7.35  | 5.29 |
| 0329LRTM05000400HP | 125-110        | 305 | 80  | 75  | 150 | 7.35  | 6.47 |
| 0329LRTM05000300HP | 140-90         | 253 | 75  | 75  | 155 | 8.23  | 5.29 |
| 0329LRTM05000400HP | 140-110        | 253 | 70  | 80  | 160 | 8.23  | 6.47 |
| 0329LRTM06000200HP | 160-63         | 333 | 100 | 80  | 175 | 9.41  | 3.70 |
| 0329LRTM06000250HP | 160-75         | 333 | 100 | 80  | 175 | 9.41  | 4.41 |
| 0329LRTM06000300HP | 160-90         | 333 | 100 | 80  | 175 | 9.41  | 5.29 |
| 0329LRTM06000400HP | 160-110        | 333 | 100 | 80  | 175 | 9.41  | 6.47 |
| 0329LRTM06000450HP | 160-125        | 380 | 98  | 100 | 190 | 9.41  | 7.35 |
| 0329LRTM07000300HP | 180-90         | 270 | 85  | 80  | 180 | 10.58 | 5.29 |
| 0329LRTM07000400HP | 180-110        | 270 | 85  | 85  | 185 | 10.58 | 6.47 |
| 0329LRTM07000450HP | 180-125        | 400 | 90  | 85  | 185 | 10.58 | 7.35 |
| 0329LRTM08000200HP | 200-63         | 338 | 95  | 75  | 195 | 11.76 | 3.70 |
| 0329LRTM08000250HP | 200-75         | 338 | 95  | 80  | 195 | 11.76 | 4.41 |
| 0329LRTM08000300HP | 200-90         | 338 | 95  | 85  | 195 | 11.76 | 5.29 |

| PART #             | DIAMETER<br>Ød | L   | L1  | L2  | H   | S1    | S2    |
|--------------------|----------------|-----|-----|-----|-----|-------|-------|
| O329LRTM08000400HP | 200-110        | 338 | 95  | 85  | 195 | 11.76 | 6.47  |
| O329LRTM08000600HP | 200-160        | 368 | 95  | 85  | 200 | 11.76 | 9.41  |
| O329LRTM09000300HP | 225-90         | 285 | 90  | 75  | 200 | 13.23 | 5.29  |
| O329LRTM09000400HP | 225-110        | 285 | 85  | 75  | 200 | 13.23 | 6.47  |
| O329LRTM09000600HP | 225-160        | 335 | 85  | 75  | 200 | 13.23 | 9.41  |
| O329LRTM09000700HP | 225-180        | 400 | 85  | 75  | 200 | 13.23 | 10.58 |
| O329LRTM10000200HP | 250-63         | 365 | 110 | 85  | 235 | 14.70 | 3.70  |
| O329LRTM10000250HP | 250-75         | 365 | 110 | 90  | 235 | 14.70 | 4.41  |
| O329LRTM10000300HP | 250-90         | 365 | 110 | 100 | 245 | 14.70 | 5.29  |
| O329LRTM10000400HP | 250-110        | 365 | 110 | 110 | 245 | 14.70 | 6.47  |
| O329LRTM10000600HP | 250-160        | 505 | 110 | 110 | 250 | 14.70 | 9.41  |
| O329LRTM10000800HP | 250-200        | 505 | 110 | 110 | 250 | 14.70 | 11.76 |
| O329LRTM11000400HP | 280-110        | 300 | 100 | 100 | 240 | 16.47 | 6.47  |
| O329LRTM11000600HP | 280-160        | 387 | 100 | 100 | 250 | 16.47 | 9.41  |
| O329LRTM11000800HP | 280-200        | 387 | 100 | 105 | 250 | 16.47 | 11.76 |
| O329LRTM12000200HP | 315-63         | 370 | 110 | 90  | 270 | 18.52 | 3.70  |
| O329LRTM12000250HP | 315-75         | 370 | 110 | 90  | 270 | 18.52 | 4.41  |
| O329LRTM12000300HP | 315-90         | 370 | 110 | 100 | 280 | 18.52 | 5.29  |
| O329LRTM12000400HP | 315-110        | 370 | 110 | 110 | 280 | 18.52 | 6.47  |
| O329LRTM12000600HP | 315-160        | 460 | 110 | 110 | 285 | 18.52 | 9.41  |
| O329LRTM12000800HP | 315-200        | 460 | 110 | 110 | 285 | 18.52 | 11.76 |
| O329LRTM12001000HP | 315-250        | 575 | 103 | 110 | 285 | 18.52 | 14.70 |
| O329LRTM14000300HP | 355-90         | 330 | 110 | 100 | 287 | 20.88 | 5.29  |
| O329LRTM14000400HP | 355-110        | 350 | 110 | 100 | 287 | 20.88 | 6.47  |
| O329LRTM14000600HP | 355-160        | 400 | 110 | 100 | 287 | 20.88 | 9.41  |
| O329LRTM14000800HP | 355-200        | 440 | 110 | 100 | 287 | 20.88 | 11.76 |
| O329LRTM14001000HP | 355-250        | 490 | 110 | 100 | 287 | 20.88 | 14.70 |
| O329LRTM14001200HP | 355-315        | 555 | 110 | 100 | 287 | 20.88 | 18.52 |
| O329LRTM16000300HP | 400-90         | 340 | 110 | 100 | 310 | 23.52 | 5.29  |
| O329LRTM16000400HP | 400-110        | 360 | 110 | 100 | 310 | 23.52 | 6.47  |
| O329LRTM16000600HP | 400-160        | 400 | 110 | 100 | 310 | 23.52 | 9.41  |
| O329LRTM16000800HP | 400-200        | 450 | 110 | 100 | 310 | 23.52 | 11.76 |
| O329LRTM16001000HP | 400-250        | 490 | 110 | 100 | 310 | 23.52 | 14.70 |
| O329LRTM16001200HP | 400-315        | 555 | 110 | 100 | 310 | 23.52 | 18.52 |

| PART #             | DIAMETER<br>ød | L   | L1  | L2  | H   | S1    | S2    |
|--------------------|----------------|-----|-----|-----|-----|-------|-------|
| 0329LRTM16001400HP | 400-355        | 595 | 110 | 100 | 310 | 23.52 | 20.88 |
| 0329LRTM18000400HP | 450-110        | 375 | 120 | 120 | 365 | 26.47 | 6.47  |
| 0329LRTM18000450HP | 450-125        | 464 | 150 | 120 | 365 | 26.47 | 7.35  |
| 0329LRTM18000600HP | 450-160        | 464 | 130 | 120 | 365 | 26.47 | 9.41  |
| 0329LRTM18000800HP | 450-200        | 464 | 120 | 120 | 365 | 26.47 | 11.76 |
| 0329LRTM18000900HP | 450-225        | 545 | 150 | 130 | 375 | 26.47 | 13.23 |
| 0329LRTM18001000HP | 450-250        | 545 | 140 | 130 | 375 | 26.47 | 14.70 |
| 0329LRTM18001100HP | 450-280        | 600 | 140 | 140 | 385 | 26.47 | 16.47 |
| 0329LRTM18001200HP | 450-315        | 600 | 130 | 140 | 385 | 26.47 | 18.52 |
| 0329LRTM18001400HP | 450-355        | 660 | 140 | 160 | 405 | 26.47 | 20.88 |
| 0329LRTM18001600HP | 450-400        | 670 | 120 | 160 | 405 | 26.47 | 23.52 |
| 0329LRTM20000400HP | 500-110        | 398 | 130 | 135 | 420 | 29.41 | 6.47  |
| 0329LRTM20000600HP | 500-160        | 495 | 140 | 135 | 420 | 29.41 | 9.41  |



|                    |         |     |     |     |     |       |       |
|--------------------|---------|-----|-----|-----|-----|-------|-------|
| 0329LRTM20000900HP | 500-225 | 545 | 150 | 135 | 420 | 29.41 | 13.23 |
| 0329LRTM20001200HP | 500-315 | 635 | 145 | 145 | 430 | 29.41 | 18.52 |
| 0329LRTM22000400HP | 560-110 | 410 | 135 | 140 | 445 | 32.94 | 6.47  |
| 0329LRTM22000600HP | 560-160 | 450 | 135 | 140 | 445 | 32.94 | 9.41  |
| 0329LRTM22000800HP | 560-200 | 508 | 135 | 140 | 445 | 32.94 | 11.76 |
| 0329LRTM22001000HP | 560-250 | 545 | 135 | 140 | 445 | 32.94 | 14.70 |
| 0329LRTM22001200HP | 560-315 | 605 | 135 | 145 | 450 | 32.94 | 18.52 |
| 0329LRTM22001600HP | 560-400 | 720 | 135 | 160 | 465 | 32.94 | 23.52 |
| 0329LRTM24000400HP | 630-110 | 475 | 145 | 135 | 480 | 37.05 | 6.47  |



| PART #             | DIAMETER<br>Ød | L    | L1  | L2  | H   | S1    | S2    |
|--------------------|----------------|------|-----|-----|-----|-------|-------|
| O329LRTM24000600HP | 630-160        | 475  | 140 | 140 | 485 | 37.05 | 9.41  |
| O329LRTM24000800HP | 630-200        | 550  | 150 | 145 | 490 | 37.05 | 11.76 |
| O329LRTM24001000HP | 630-250        | 555  | 140 | 145 | 490 | 37.05 | 14.70 |
| O329LRTM24001200HP | 630-315        | 665  | 150 | 145 | 490 | 37.05 | 18.52 |
| O329LRTM24001600HP | 630-400        | 725  | 145 | 160 | 505 | 37.05 | 23.52 |
| O329LRTM24001800HP | 630-450        | 800  | 150 | 180 | 525 | 37.05 | 26.47 |
| O329LRTM28000400HP | 710-110        | 505  | 190 | 160 | 520 | 41.76 | 6.47  |
| O329LRTM28000500HP | 710-160        | 545  | 190 | 160 | 520 | 41.76 | 9.41  |
| O329LRTM28001000HP | 710-250        | 630  | 190 | 160 | 520 | 41.76 | 14.70 |
| O329LRTM28001600HP | 710-400        | 790  | 195 | 175 | 535 | 41.76 | 23.52 |
| O329LRTM32000400HP | 800-110        | 500  | 180 | 160 | 570 | 47.05 | 6.47  |
| O329LRTM32000600HP | 800-160        | 590  | 200 | 160 | 570 | 47.05 | 9.41  |
| O329LRTM32001000HP | 800-250        | 630  | 170 | 160 | 570 | 47.05 | 14.70 |
| O329LRTM32001200HP | 800-315        | 720  | 190 | 160 | 570 | 47.05 | 18.52 |
| O329LRTM32001600HP | 800-400        | 800  | 190 | 180 | 590 | 47.05 | 23.52 |
| O329LRTM32002400HP | 800-630        | 1020 | 190 | 210 | 620 | 47.05 | 37.05 |

**PE 100**

# REDUCING TEE

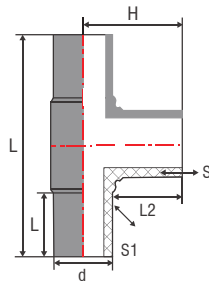
**SDR 11 - PN 16**

| PART #            | DIAMETER<br>Ød | L   | L1  | L2  | H   | S1    | S     |
|-------------------|----------------|-----|-----|-----|-----|-------|-------|
| O329LRM02500150HP | 75-50          | 199 | 70  | 55  | 94  | 6.81  | 4.54  |
| O329LRM03000150HP | 90-50          | 243 | 80  | 65  | 115 | 8.18  | 4.54  |
| O329LRM02500200HP | 90-63          | 243 | 80  | 68  | 123 | 8.18  | 5.72  |
| O329LRM02500250HP | 90-75          | 270 | 80  | 75  | 130 | 8.18  | 6.81  |
| O329LRM04000150HP | 110-50         | 242 | 83  | 60  | 125 | 10    | 4.54  |
| O329LRM04000200HP | 110-63         | 242 | 83  | 62  | 130 | 10    | 5.72  |
| O329LRM04000250HP | 110-75         | 275 | 83  | 80  | 138 | 10    | 6.81  |
| O329LRM04000300HP | 110-90         | 275 | 83  | 82  | 140 | 10    | 8.18  |
| O329LRM04500300HP | 125-90         | 305 | 80  | 75  | 150 | 11.36 | 8.18  |
| O329LRM04500400HP | 125-110        | 305 | 80  | 75  | 150 | 11.36 | 10    |
| O329LRM05000300HP | 140-90         | 253 | 75  | 75  | 155 | 8.23  | 8.18  |
| O329LRM05000400HP | 140-110        | 253 | 70  | 80  | 160 | 8.23  | 10    |
| O329LRM06000200HP | 160-63         | 333 | 100 | 80  | 175 | 14.54 | 5.72  |
| O329LRM06000250HP | 160-75         | 333 | 100 | 80  | 175 | 14.54 | 6.81  |
| O329LRM06000300HP | 160-90         | 333 | 100 | 80  | 175 | 14.54 | 8.18  |
| O329LRM06000400HP | 160-110        | 333 | 100 | 80  | 175 | 14.54 | 10    |
| O329LRM06000450HP | 160-125        | 380 | 98  | 100 | 190 | 14.54 | 11.36 |
| O329LRM07000300HP | 180-90         | 270 | 85  | 80  | 180 | 16.36 | 8.18  |
| O329LRM07000400HP | 180-110        | 270 | 85  | 85  | 185 | 16.36 | 10    |
| O329LRM07000450HP | 180-125        | 400 | 90  | 85  | 185 | 16.36 | 11.36 |
| O329LRM08000200HP | 200-63         | 338 | 95  | 75  | 195 | 18.18 | 5.72  |
| O329LRM08000250HP | 200-75         | 338 | 95  | 80  | 195 | 18.18 | 6.81  |
| O329LRM08000300HP | 200-90         | 338 | 95  | 85  | 195 | 18.18 | 8.18  |

| PART #             | DIAMETER<br>Ød | L   | L1  | L2  | H   | S1    | S2    |
|--------------------|----------------|-----|-----|-----|-----|-------|-------|
| 0329LRTM08000400HP | 200-110        | 338 | 95  | 85  | 195 | 18.18 | 10    |
| 0329LRTM08000600HP | 200-160        | 368 | 95  | 85  | 200 | 18.18 | 14.54 |
| 0329LRTM09000300HP | 225-90         | 285 | 90  | 75  | 200 | 20.45 | 8.18  |
| 0329LRTM09000400HP | 225-110        | 285 | 85  | 75  | 200 | 20.45 | 10    |
| 0329LRTM09000600HP | 225-160        | 335 | 85  | 75  | 200 | 20.45 | 14.54 |
| 0329LRTM09000700HP | 225-180        | 400 | 85  | 75  | 200 | 20.45 | 16.36 |
| 0329LRTM10000200HP | 250-63         | 365 | 110 | 85  | 235 | 22.72 | 5.72  |
| 0329LRTM10000250HP | 250-75         | 365 | 110 | 90  | 235 | 22.72 | 6.81  |
| 0329LRTM10000300HP | 250-90         | 365 | 110 | 100 | 245 | 22.72 | 8.18  |
| 0329LRTM10000400HP | 250-110        | 365 | 110 | 110 | 245 | 22.72 | 10    |
| 0329LRTM10000600HP | 250-160        | 505 | 110 | 110 | 250 | 22.72 | 14.54 |
| 0329LRTM10000800HP | 250-200        | 505 | 110 | 110 | 250 | 22.72 | 18.18 |
| 0329LRTM11000400HP | 280-110        | 300 | 100 | 100 | 240 | 25.45 | 10    |
| 0329LRTM11000600HP | 280-160        | 387 | 100 | 100 | 250 | 25.45 | 14.54 |
| 0329LRTM11000800HP | 280-200        | 387 | 100 | 105 | 250 | 25.45 | 18.18 |
| 0329LRTM12000200HP | 315-63         | 370 | 110 | 90  | 270 | 28.63 | 5.72  |
| 0329LRTM12000250HP | 315-75         | 370 | 110 | 90  | 270 | 28.63 | 6.81  |
| 0329LRTM12000300HP | 315-90         | 370 | 110 | 100 | 280 | 28.63 | 8.18  |
| 0329LRTM12000400HP | 315-110        | 370 | 110 | 110 | 280 | 28.63 | 10    |
| 0329LRTM12000600HP | 315-160        | 460 | 110 | 110 | 285 | 28.63 | 14.5  |
| 0329LRTM12000800HP | 315-200        | 460 | 110 | 110 | 285 | 28.63 | 18.18 |
| 0329LRTM12001000HP | 315-250        | 575 | 103 | 110 | 285 | 28.63 | 22.72 |
| 0329LRTM12000800HP | 355-90         | 330 | 110 | 100 | 287 | 32.27 | 8.18  |
| 0329LRTM14000400HP | 355-110        | 350 | 110 | 100 | 287 | 32.27 | 10    |
| 0329LRTM14000600HP | 355-160        | 400 | 110 | 100 | 287 | 32.27 | 14.5  |
| 0329LRTM14000800HP | 355-200        | 440 | 110 | 100 | 287 | 32.27 | 18.18 |
| 0329LRTM14001000HP | 355-250        | 490 | 110 | 100 | 287 | 32.27 | 22.72 |
| 0329LRTM14001200HP | 355-315        | 555 | 110 | 100 | 287 | 30.27 | 28.63 |
| 0329LRTM16000300HP | 400-90         | 340 | 110 | 100 | 310 | 36.36 | 8.18  |
| 0329LRTM16000400HP | 400-110        | 360 | 110 | 100 | 310 | 36.36 | 10    |
| 0329LRTM16000600HP | 400-160        | 400 | 110 | 100 | 310 | 36.36 | 14.5  |
| 0329LRTM16000800HP | 400-200        | 450 | 110 | 100 | 310 | 36.36 | 18.18 |
| 0329LRTM16001000HP | 400-250        | 490 | 110 | 100 | 310 | 36.36 | 22.72 |
| 0329LRTM16001200HP | 400-315        | 555 | 110 | 100 | 310 | 36.36 | 28.63 |



| PART #             | DIAMETER<br>Ød | L   | L1  | L2  | H   | S1    | S2    |
|--------------------|----------------|-----|-----|-----|-----|-------|-------|
| O329LRTM16001400HP | 400-355        | 595 | 110 | 100 | 310 | 36.36 | 32.27 |
| O329LRTM18000400HP | 450-110        | 375 | 120 | 120 | 365 | 40.90 | 10    |
| O329LRTM18000450HP | 450-125        | 464 | 150 | 120 | 365 | 40.90 | 10.90 |
| O329LRTM18000600HP | 450-160        | 464 | 130 | 120 | 365 | 40.90 | 14.54 |
| O329LRTM18000800HP | 450-200        | 464 | 120 | 120 | 365 | 40.90 | 18.18 |
| O329LRTM18000900HP | 450-225        | 545 | 150 | 130 | 375 | 40.90 | 20.45 |
| O329LRTM18001000HP | 450-250        | 545 | 140 | 130 | 375 | 40.90 | 22.72 |
| O329LRTM18001100HP | 450-280        | 600 | 140 | 140 | 385 | 40.90 | 25.45 |
| O329LRTM18001200HP | 450-315        | 600 | 130 | 140 | 385 | 40.90 | 28.63 |
| O329LRTM18000600HP | 450-355        | 660 | 140 | 160 | 405 | 40.90 | 32.27 |
| O329LRTM18001600HP | 450-400        | 670 | 120 | 160 | 405 | 40.90 | 36.36 |
| O329LRTM20000400HP | 500-110        | 398 | 130 | 135 | 420 | 45.45 | 10    |
| O329LRTM20000600HP | 500-160        | 495 | 140 | 135 | 420 | 45.45 | 14.54 |
| O329LRTM20000900HP | 500-225        | 545 | 150 | 135 | 420 | 45.45 | 20.45 |
| O329LRTM20001200HP | 500-315        | 635 | 145 | 145 | 430 | 45.45 | 28.63 |
| O329LRTM22000400HP | 560-110        | 410 | 135 | 140 | 445 | 50.90 | 10    |
| O329LRTM22000600HP | 560-160        | 450 | 135 | 140 | 445 | 50.90 | 14.54 |
| O329LRTM22000800HP | 560-200        | 508 | 135 | 140 | 445 | 50.90 | 18.18 |
| O329LRTM22001000HP | 560-250        | 545 | 135 | 140 | 445 | 50.90 | 22.72 |
| O329LRTM22001200HP | 560-315        | 605 | 135 | 145 | 450 | 50.90 | 28.63 |
| O329LRTM22001600HP | 560-400        | 720 | 135 | 160 | 465 | 50.90 | 36.36 |
| O329LRTM24000400HP | 630-110        | 475 | 145 | 135 | 480 | 57.27 | 10    |



| PART #             | DIAMETER<br>Ød | L   | L1  | L2  | H   | S1    | S2    |
|--------------------|----------------|-----|-----|-----|-----|-------|-------|
| O329LRTM24000600HP | 630-160        | 475 | 140 | 140 | 485 | 57.27 | 14.54 |
| O329LRTM24000800HP | 630-200        | 550 | 150 | 145 | 490 | 57.27 | 18.18 |
| O329LRTM24001000HP | 630-250        | 555 | 140 | 145 | 490 | 57.27 | 22.72 |
| O329LRTM24001200HP | 630-315        | 665 | 150 | 145 | 490 | 57.27 | 28.63 |
| O329LRTM24001600HP | 630-400        | 725 | 145 | 160 | 505 | 57.27 | 36.36 |
| O329LRTM24001800HP | 630-450        | 800 | 150 | 180 | 525 | 57.27 | 40.90 |



**PE 100**  
**REDUCER**  
**SDR 17 - PN 10**

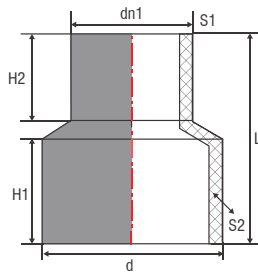

| PART #             | DIAMETER<br>Ød | L   | H1 | H2 | S1   | S2   |
|--------------------|----------------|-----|----|----|------|------|
| 0329LRTM02500150HP | 75-50          | 130 | 56 | 58 | 4.41 | 2.94 |
| 0329LRTM02500200HP | 75-63          | 130 | 59 | 64 | 4.41 | 3.70 |
| 0329LRTM03000150HP | 90-50          | 138 | 63 | 52 | 5.29 | 2.94 |
| 0329LRTM03000150HP | 90-50          | 138 | 63 | 53 | 5.29 | 2.94 |
| 0329LRTM03000200HP | 90-63          | 138 | 63 | 60 | 5.29 | 3.70 |
| 0329LRTM03000200HP | 90-63          | 172 | 78 | 60 | 5.29 | 3.70 |
| 0329LRTM03000250HP | 90-75          | 172 | 78 | 60 | 5.29 | 4.41 |
| 0329LRTM03000250HP | 90-75          | 172 | 78 | 65 | 5.29 | 4.41 |
| 0329LRTM04000150HP | 110-50         | 172 | 78 | 65 | 6.47 | 2.94 |
| 0329LRTM04000150HP | 110-50         | 183 | 78 | 70 | 6.47 | 2.94 |
| 0329LRTM04000200HP | 110-63         | 183 | 78 | 68 | 6.47 | 3.70 |
| 0329LRTM04000200HP | 110-63         | 183 | 78 | 68 | 6.47 | 3.70 |
| 0329LRTM04000250HP | 110-75         | 183 | 78 | 72 | 6.47 | 4.41 |
| 0329LRTM04000250HP | 110-75         | 180 | 80 | 65 | 6.47 | 4.41 |
| 0329LRTM04000300HP | 110-90         | 180 | 80 | 70 | 6.47 | 5.29 |
| 0329LRTM04000300HP | 110-90         | 180 | 80 | 70 | 6.47 | 5.29 |
| 0329LRTM04500300HP | 125-90         | 180 | 80 | 75 | 7.35 | 5.29 |
| 0329LRTM04500400HP | 125-110        | 180 | 80 | 70 | 7.35 | 6.47 |
| 0329LRTM06000200HP | 160-63         | 203 | 85 | 67 | 9.41 | 3.70 |



| PART #             | DIAMETER<br>Ød | L   | H1  | H2  | S1    | S2    |
|--------------------|----------------|-----|-----|-----|-------|-------|
| 0329LRTM06000250HP | 160-75         | 208 | 85  | 75  | 9.41  | 4.41  |
| 0329LRTM06000300HP | 160-90         | 214 | 85  | 83  | 9.41  | 5.29  |
| 0329LRTM06000400HP | 160-110        | 214 | 85  | 83  | 9.41  | 6.47  |
| 0329LRTM06000450HP | 160-125        | 214 | 85  | 85  | 9.41  | 7.35  |
| 0329LRTM07000400HP | 180-110        | 170 | 85  | 80  | 10.58 | 6.47  |
| 0329LRTM07000450HP | 180-125        | 170 | 85  | 80  | 10.58 | 7.35  |
| 0329LRTM08000200HP | 200-63         | 218 | 100 | 67  | 11.76 | 3.70  |
| 0329LRTM08000250HP | 200-75         | 218 | 100 | 75  | 11.76 | 4.41  |
| 0329LRTM08000300HP | 200-90         | 218 | 100 | 93  | 11.76 | 5.29  |
| 0329LRTM08000400HP | 200-110        | 218 | 100 | 97  | 11.76 | 6.47  |
| 0329LRTM08000600HP | 200-160        | 210 | 100 | 100 | 11.76 | 9.41  |
| 0329LRTM08000700HP | 200-180        | 210 | 100 | 108 | 11.76 | 10.58 |
| 0329LRTM09000400HP | 225-110        | 218 | 80  | 87  | 13.23 | 6.47  |
| 0329LRTM09000600HP | 225-160        | 218 | 80  | 80  | 13.23 | 9.41  |
| 0329LRTM09000800HP | 225-200        | 218 | 80  | 90  | 13.23 | 11.76 |
| 0329LRTM10000400HP | 250-110        | 260 | 90  | 100 | 14.70 | 6.47  |
| 0329LRTM10000600HP | 250-160        | 230 | 90  | 93  | 14.70 | 9.41  |
| 0329LRTM10000800HP | 250-200        | 230 | 90  | 97  | 14.70 | 11.76 |

| PART #             | DIAMETER<br>Ød | L   | H1  | H2  | S1    | S2    |
|--------------------|----------------|-----|-----|-----|-------|-------|
| 0329LRTM10000900HP | 250-225        | 230 | 90  | 100 | 14.70 | 13.23 |
| 0329LRTM11000400HP | 280-110        | 255 | 105 | 95  | 16.47 | 6.47  |
| 0329LRTM11000600HP | 280-160        | 245 | 105 | 105 | 16.47 | 9.41  |
| 0329LRTM11000700HP | 280-180        | 245 | 105 | 105 | 16.47 | 10.58 |
| 0329LRTM11000800HP | 280-200        | 245 | 105 | 120 | 16.47 | 11.76 |
| 0329LRTM11001000HP | 280-250        | 245 | 105 | 130 | 16.47 | 14.70 |
| 0329LRTM12000400HP | 315-110        | 235 | 90  | 87  | 18.52 | 6.47  |
| 0329LRTM12000600HP | 315-160        | 235 | 90  | 85  | 18.52 | 9.41  |
| 0329LRTM12000800HP | 315-200        | 240 | 90  | 90  | 18.52 | 11.76 |
| 0329LRTM12001000HP | 315-250        | 240 | 90  | 100 | 18.52 | 14.70 |
| 0329LRTM14000400HP | 355-110        | 270 | 105 | 100 | 20.88 | 6.47  |
| 0329LRTM14000600HP | 355-160        | 275 | 105 | 110 | 20.88 | 9.41  |
| 0329LRTM14000800HP | 355-200        | 260 | 105 | 110 | 20.88 | 11.76 |
| 0329LRTM14001000HP | 355-250        | 240 | 105 | 110 | 20.88 | 14.70 |
| 0329LRTM16000800HP | 400-200        | 270 | 100 | 110 | 23.52 | 11.76 |
| 0329LRTM16001000HP | 400-250        | 250 | 100 | 110 | 23.52 | 14.70 |
| 0329LRTM16001200HP | 400-315        | 230 | 100 | 110 | 23.52 | 18.52 |
| 0329LRTM18000800HP | 450-200        | 270 | 105 | 100 | 26.47 | 11.76 |
| 0329LRTM18001000HP | 450-250        | 270 | 105 | 110 | 26.47 | 14.70 |
| 0329LRTM18001200HP | 450-315        | 250 | 105 | 110 | 26.47 | 18.52 |
| 0329LRTM18001600HP | 450-400        | 245 | 105 | 120 | 26.47 | 23.52 |
| 0329LRTM20000800HP | 500-200        | 280 | 98  | 105 | 29.41 | 11.76 |
| 0329LRTM20001000HP | 500-250        | 280 | 98  | 110 | 29.41 | 14.70 |
| 0329LRTM20001200HP | 500-315        | 275 | 98  | 110 | 29.41 | 18.52 |
| 0329LRTM20001600HP | 500-400        | 275 | 98  | 120 | 29.41 | 23.52 |
| 0329LRTM20001800HP | 500-450        | 275 | 98  | 120 | 29.41 | 26.47 |
| 0329LRTM22001200HP | 560-315        | 280 | 105 | 110 | 32.94 | 18.52 |
| 0329LRTM22001600HP | 560-400        | 260 | 105 | 120 | 32.94 | 23.52 |
| 0329LRTM22001800HP | 560-450        | 250 | 105 | 120 | 32.94 | 26.47 |
| 0329LRTM24001200HP | 630-315        | 285 | 110 | 100 | 37.05 | 18.52 |
| 0329LRTM24001600HP | 630-400        | 285 | 110 | 120 | 37.05 | 23.52 |
| 0329LRTM24001800HP | 630-450        | 275 | 110 | 120 | 37.05 | 26.47 |

## PE 100 REDUCER SDR 11 - PN 16

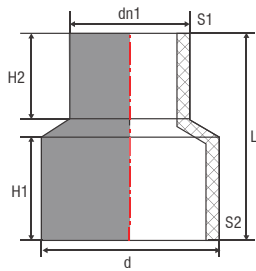

| PART #             | DIAMETER<br>Ød | L   | H1 | H2 | S1    | S2   |
|--------------------|----------------|-----|----|----|-------|------|
| 0329LRTM02500150HP | 75-50          | 130 | 56 | 58 | 6.8   | 4.5  |
| 0329LRTM02500200HP | 75-63          | 130 | 59 | 64 | 6.8   | 5.72 |
| 0329LRTM03000150HP | 90-50          | 138 | 63 | 52 | 8.18  | 4.5  |
| 0329LRTM03000150HP | 90-50          | 138 | 63 | 53 | 8.18  | 4.5  |
| 0329LRTM03000200HP | 90-63          | 138 | 63 | 60 | 8.18  | 5.72 |
| 0329LRTM03000200HP | 90-63          | 172 | 78 | 60 | 8.18  | 5.72 |
| 0329LRTM03000250HP | 90-75          | 172 | 78 | 60 | 8.18  | 6.8  |
| 0329LRTM03000250HP | 90-75          | 172 | 78 | 65 | 8.18  | 6.8  |
| 0329LRTM04000150HP | 110-50         | 172 | 78 | 65 | 10    | 4.54 |
| 0329LRTM04000150HP | 110-50         | 183 | 78 | 70 | 10    | 4.54 |
| 0329LRTM04000200HP | 110-63         | 183 | 78 | 68 | 10    | 5.72 |
| 0329LRTM04000200HP | 110-63         | 183 | 78 | 68 | 10    | 5.72 |
| 0329LRTM04000250HP | 110-75         | 183 | 78 | 72 | 10    | 6.8  |
| 0329LRTM04000250HP | 110-75         | 180 | 80 | 65 | 10    | 6.8  |
| 0329LRTM04000300HP | 110-90         | 180 | 80 | 70 | 10    | 8.18 |
| 0329LRTM04000300HP | 110-90         | 180 | 80 | 70 | 10    | 8.18 |
| 0329LRTM04500300HP | 125-90         | 180 | 80 | 75 | 11.36 | 8.18 |
| 0329LRTM04500400HP | 125-110        | 180 | 80 | 70 | 11.36 | 10   |
| 0329LRTM06000200HP | 160-63         | 203 | 85 | 67 | 14.54 | 5.72 |



| PART #             | DIAMETER<br>Ød | L   | H1  | H2  | S1    | S2    |
|--------------------|----------------|-----|-----|-----|-------|-------|
| 0329LRTM06000250HP | 160-75         | 208 | 85  | 75  | 14.54 | 6.8   |
| 0329LRTM06000300HP | 160-90         | 214 | 85  | 83  | 14.54 | 8.18  |
| 0329LRTM06000400HP | 160-110        | 214 | 85  | 83  | 14.54 | 10    |
| 0329LRTM06000450HP | 160-125        | 214 | 85  | 85  | 14.54 | 11.36 |
| 0329LRTM07000400HP | 180-110        | 170 | 85  | 80  | 16.36 | 10    |
| 0329LRTM07000450HP | 180-125        | 170 | 85  | 80  | 16.36 | 11.36 |
| 0329LRTM08000200HP | 200-63         | 218 | 100 | 67  | 11.76 | 5.72  |
| 0329LRTM08000250HP | 200-75         | 218 | 100 | 75  | 11.76 | 6.8   |
| 0329LRTM08000300HP | 200-90         | 218 | 100 | 93  | 11.76 | 8.18  |
| 0329LRTM08000400HP | 200-110        | 218 | 100 | 97  | 11.76 | 10    |
| 0329LRTM08000600HP | 200-160        | 210 | 100 | 100 | 11.76 | 14.54 |
| 0329LRTM08000700HP | 200-180        | 210 | 100 | 108 | 11.76 | 16.36 |
| 0329LRTM09000400HP | 225-110        | 218 | 80  | 87  | 20.45 | 10    |
| 0329LRTM08000600HP | 225-160        | 218 | 80  | 80  | 20.45 | 14.54 |
| 0329LRTM09000800HP | 225-200        | 218 | 80  | 90  | 20.45 | 18.18 |
| 0329LRTM10000400HP | 250-110        | 260 | 90  | 100 | 22.72 | 10    |
| 0329LRTM10000600HP | 250-160        | 230 | 90  | 93  | 22.72 | 14.54 |
| 0329LRTM10000800HP | 250-200        | 230 | 90  | 97  | 22.72 | 18.18 |

| PART #             | DIAMETER<br>Ød | L   | H1  | H2  | S1    | S2    |
|--------------------|----------------|-----|-----|-----|-------|-------|
| 0329LRTM10000900HP | 250-225        | 230 | 90  | 100 | 22.72 | 20.45 |
| 0329LRTM11000400HP | 280-110        | 255 | 105 | 95  | 25.45 | 10    |
| 0329LRTM11000400HP | 280-160        | 245 | 105 | 105 | 25.45 | 14.54 |
| 0329LRTM11000700HP | 280-180        | 245 | 105 | 105 | 25.45 | 16.36 |
| 0329LRTM11000800HP | 280-200        | 245 | 105 | 120 | 25.45 | 18.18 |
| 0329LRTM11001000HP | 280-250        | 245 | 105 | 130 | 25.45 | 22.72 |
| 0329LRTM12000400HP | 315-110        | 235 | 90  | 87  | 28.63 | 10    |
| 0329LRTM12000600HP | 315-160        | 235 | 90  | 85  | 28.63 | 14.54 |
| 0329LRTM12000800HP | 315-200        | 240 | 90  | 90  | 28.63 | 18.18 |
| 0329LRTM12001000HP | 315-250        | 240 | 90  | 100 | 28.63 | 22.72 |
| 0329LRTM14000400HP | 355-110        | 270 | 105 | 100 | 32.27 | 10    |
| 0329LRTM14000600HP | 355-160        | 275 | 105 | 110 | 32.27 | 14.54 |
| 0329LRTM14000800HP | 355-200        | 260 | 105 | 110 | 32.27 | 18.18 |
| 0329LRTM14001000HP | 355-250        | 240 | 105 | 110 | 32.27 | 22.72 |
| 0329LRTM16000900HP | 400-200        | 270 | 100 | 110 | 36.36 | 18.18 |
| 0329LRTM16001000HP | 400-250        | 250 | 100 | 110 | 36.36 | 22.72 |
| 0329LRTM16001200HP | 400-315        | 230 | 100 | 110 | 36.36 | 28.63 |
| 0329LRTM18000800HP | 450-200        | 270 | 105 | 100 | 40.90 | 18.18 |
| 0329LRTM18001000HP | 450-250        | 270 | 105 | 110 | 40.90 | 22.72 |
| 0329LRTM18001200HP | 450-315        | 250 | 105 | 110 | 40.90 | 28.63 |
| 0329LRTM18001600HP | 450-400        | 245 | 105 | 120 | 40.90 | 36.36 |
| 0329LRTM20000800HP | 500-200        | 280 | 98  | 105 | 45.45 | 18.18 |
| 0329LRTM20001000HP | 500-250        | 280 | 98  | 110 | 45.45 | 22.72 |
| 0329LRTM20001200HP | 500-315        | 275 | 98  | 110 | 45.45 | 28.63 |
| 0329LRTM20001600HP | 500-400        | 275 | 98  | 120 | 45.45 | 36.36 |
| 0329LRTM20001800HP | 500-450        | 275 | 98  | 120 | 45.45 | 40.90 |
| 0329LRTM22001200HP | 560-315        | 280 | 105 | 110 | 50.90 | 28.63 |
| 0329LRTM22001600HP | 560-400        | 260 | 105 | 120 | 50.90 | 36.36 |
| 0329LRTM22001800HP | 560-450        | 250 | 105 | 120 | 50.90 | 40.90 |
| 0329LRTM22001200HP | 630-315        | 285 | 110 | 100 | 57.27 | 28.63 |
| 0329LRTM22001600HP | 630-400        | 285 | 110 | 120 | 57.27 | 36.36 |
| 0329LRTM22001800HP | 630-450        | 275 | 110 | 120 | 57.27 | 40.90 |

**PE 100**

# CROSS TEE

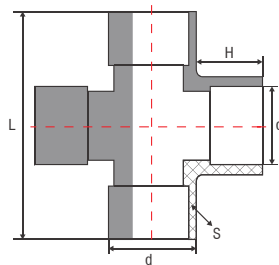
**SDR 17 - PN 10**

| PART #         | DIAMETER<br>Ød | L    | H   | S     |
|----------------|----------------|------|-----|-------|
| 0329LCRS0200HP | 63             | 184  | 60  | 3.71  |
| 0329LCRS0250HP | 75             | 203  | 65  | 4.41  |
| 0329LCRS0300HP | 90             | 240  | 75  | 5.29  |
| 0329LCRS0400HP | 110            | 275  | 85  | 6.47  |
| 0329LCRS0450HP | 125            | 295  | 85  | 7.35  |
| 0329LCRS0600HP | 160            | 370  | 105 | 9.41  |
| 0329LCRS0800HP | 200            | 435  | 110 | 11.76 |
| 0329LCRS0900HP | 225            | 442  | 110 | 13.24 |
| 0329LCRS1000HP | 250            | 493  | 120 | 14.71 |
| 0329LCRS1200HP | 315            | 558  | 120 | 18.53 |
| 0329LCRS1400HP | 355            | 640  | 140 | 20.88 |
| 0329LCRS1600HP | 400            | 468  | 140 | 23.53 |
| 0329LCRS1800HP | 450            | 740  | 140 | 26.47 |
| 0329LCRS2000HP | 500            | 810  | 150 | 29.41 |
| 0329LCRS2200HP | 560            | 875  | 150 | 32.94 |
| 0329LCRS2400HP | 630            | 960  | 160 | 37.06 |
| 0329LCRS2800HP | 710            | 1140 | 210 | 41.76 |
| 0329LCRS3400HP | 800            | 1280 | 235 | 47.06 |



PE 100

## CROSS TEE

SDR 11 - PN 16

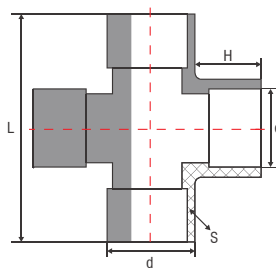

| PART #         | DIAMETER<br>Ød | L    | H   | S     |
|----------------|----------------|------|-----|-------|
| 0329NCRS0200HP | 63             | 184  | 60  | 5.73  |
| 0329NCRS0250HP | 75             | 203  | 65  | 6.82  |
| 0329NCRS0300HP | 90             | 240  | 75  | 8.18  |
| 0329NCRS0400HP | 110            | 275  | 85  | 10.00 |
| 0329NCRS0450HP | 125            | 295  | 85  | 11.36 |
| 0329NCRS0600HP | 160            | 370  | 105 | 14.55 |
| 0329NCRS0800HP | 200            | 435  | 110 | 18.18 |
| 0329NCRS0900HP | 225            | 442  | 110 | 20.45 |
| 0329NCRS1000HP | 250            | 493  | 120 | 22.73 |
| 0329NCRS1200HP | 315            | 558  | 120 | 28.64 |
| 0329NCRS1400HP | 355            | 640  | 140 | 32.27 |
| 0329NCRS1600HP | 400            | 468  | 140 | 36.36 |
| 0329NCRS1800HP | 450            | 740  | 140 | 40.91 |
| 0329NCRS2000HP | 500            | 810  | 150 | 45.45 |
| 0329NCRS2200HP | 560            | 875  | 150 | 50.91 |
| 0329NCRS2400HP | 630            | 960  | 160 | 57.27 |
| 0329NCRS2800HP | 710            | 1140 | 210 | 64.55 |
| 0329NCRS3400HP | 800            | 1280 | 235 | 72.73 |

**PE 100**

# END CAP

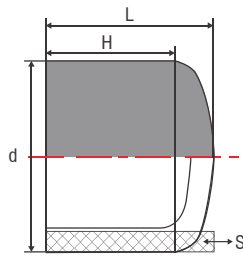
**SDR 17 - PN 10**

| PART #         | DIAMETER<br>Ød | L   | H   | S     |
|----------------|----------------|-----|-----|-------|
| O329LCAP0250HP | 75             | 45  | 35  | 4.41  |
| O329LCAP0300HP | 90             | 70  | 60  | 5.29  |
| O329LCAP0400HP | 110            | 70  | 55  | 6.47  |
| O329LCAP0450HP | 125            | 60  | 48  | 7.35  |
| O329LCAP0500HP | 140            | 85  | 70  | 8.24  |
| O329LCAP0600HP | 160            | 85  | 70  | 9.41  |
| O329LCAP0700HP | 180            | 105 | 90  | 10.59 |
| O329LCAP0800HP | 200            | 90  | 75  | 11.76 |
| O329LCAP0900HP | 225            | 130 | 115 | 13.24 |
| O329LCAP1000HP | 250            | 95  | 85  | 14.71 |
| O329LCAP1100HP | 280            | 140 | 120 | 16.47 |
| O329LCAP1200HP | 315            | 115 | 90  | 18.53 |
| O329LCAP1400HP | 355            | 140 | 115 | 20.88 |
| O329LCAP1600HP | 400            | 130 | 100 | 23.53 |
| O329LCAP1800HP | 450            | 140 | 115 | 26.47 |
| O329LCAP2000HP | 500            | 140 | 115 | 29.41 |
| O329LCAP2200HP | 560            | 150 | 115 | 32.94 |
| O329LCAP2400HP | 630            | 150 | 115 | 37.06 |
| O329LCAP2800HP | 710            | 160 | 125 | 41.76 |
| O329LCAP3400HP | 800            | 160 | 125 | 47.06 |
| O329LCAP3600HP | 900            | 160 | 125 | 52.94 |
| O329LCAP4000HP | 1000           | 160 | 125 | 58.82 |
| O329LCAP4800HP | 1200           | 200 | 155 | 70.59 |

PE 100

## END CAP

SDR 11 - PN 16

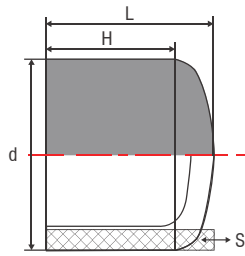

| PART #         | DIAMETER<br>Ød | L   | H   | S       |
|----------------|----------------|-----|-----|---------|
| O329LCAP0250HP | 75             | 45  | 35  | 6.82    |
| O329LCAP0300HP | 90             | 70  | 60  | 8.18    |
| O329LCAP0400HP | 110            | 70  | 55  | 10.00   |
| O329LCAP0450HP | 125            | 60  | 48  | 11.36   |
| O329LCAP0500HP | 140            | 85  | 70  | 12.73   |
| O329LCAP0600HP | 160            | 85  | 70  | 14.55   |
| O329LCAP0700HP | 180            | 105 | 90  | 16.36   |
| O329LCAP0800HP | 200            | 90  | 75  | 18.18   |
| O329LCAP0900HP | 225            | 130 | 115 | 20.45   |
| O329LCAP1000HP | 250            | 95  | 85  | 22.73   |
| O329LCAP1100HP | 280            | 140 | 120 | 25.45   |
| O329LCAP1200HP | 315            | 115 | 90  | 28.64   |
| O329LCAP1400HP | 355            | 140 | 115 | 32.27   |
| O329LCAP1600HP | 400            | 130 | 100 | 36.36   |
| O329LCAP1800HP | 450            | 140 | 115 | 40.91   |
| O329LCAP2000HP | 500            | 140 | 115 | 45.45   |
| O329LCAP2200HP | 560            | 150 | 115 | 50.91   |
| O329LCAP2400HP | 630            | 150 | 115 | 57.27   |
| O329LCAP2800HP | 710            | 160 | 125 | 64.55   |
| O329LCAP3400HP | 800            | 160 | 125 | 72.73   |
| O329LCAP3600HP | 900            | 160 | 125 | 81.82   |
| O329LCAP4000HP | 1000           | 160 | 125 | 90.91   |
| O329LCAP4800HP | 1200           | 200 | 155 | 109.09v |

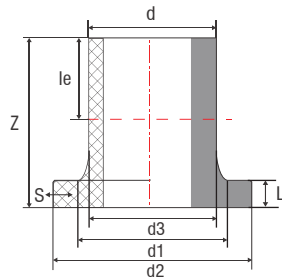
**PE 100**
**FLANGE ADAPTOR**
**SDR 17 - PN 10**

| PART #         | DIAMETER<br>Ød | d1  | d2  | d3  | le  | L  | Z   | S    |
|----------------|----------------|-----|-----|-----|-----|----|-----|------|
| 0329LFTV0200HP | 63             | 78  | 102 | -   | 88  | 14 | 120 | 3.8  |
| 0329LFTV0250HP | 75             | 92  | 122 | -   | 97  | 16 | 130 | 4.5  |
| 0329LFTV0300HP | 90             | 108 | 139 | -   | 106 | 17 | 140 | 5.4  |
| 0329LFTV0400HP | 110            | 125 | 158 | -   | 113 | 17 | 155 | 6.5  |
| 0329LFTV0450HP | 125            | 135 | 158 | -   | 120 | 20 | 160 | 7.4  |
| 0329LFTV0500HP | 140            | 155 | 188 | -   | 128 | 18 | 188 | 8.3  |
| 0329LFTV0600HP | 160            | 175 | 212 | 154 | 147 | 18 | 185 | 9.5  |
| 0329LFTV0700HP | 180            | 188 | 212 | 164 | 111 | 20 | 153 | 10.7 |
| 0329LFTV0800HP | 200            | 230 | 268 | 208 | 125 | 24 | 188 | 11.9 |
| 0329LFTV0900HP | 225            | 238 | 268 | 208 | 156 | 24 | 205 | 13.4 |
| 0329LFTV1000HP | 250            | 288 | 320 | 260 | 133 | 25 | 186 | 14.8 |
| 0329LFTV1100HP | 280            | 288 | 320 | 260 | 148 | 25 | 213 | 16.6 |
| 0329LFTV1200HP | 315            | 338 | 375 | 305 | 166 | 25 | 223 | 18.7 |
| 0329LFTV1400HP | 355            | 376 | 435 | 350 | 174 | 30 | 227 | 21.1 |
| 0329LFTV1600HP | 400            | 430 | 485 | 396 | 185 | 33 | 242 | 23.7 |
| 0329LFTV1800HP | 450            | 465 | 545 | 442 | 195 | 45 | 335 | 26.7 |
| 0329LFTV2000HP | 500            | 530 | 590 | 497 | 212 | 46 | 339 | 29.7 |
| 0329LFTV2200HP | 560            | 618 | 690 | 580 | 235 | 50 | 373 | 33.2 |
| 0329LFTV2400HP | 630            | 645 | 690 | 585 | 255 | 50 | 384 | 37.4 |



| PART #         | DIAMETER<br>Ød | d1   | d2   | d3   | le  | L  | Z   | S    |
|----------------|----------------|------|------|------|-----|----|-----|------|
| 0329LFTV2400HP | 710            | 740  | 800  | 670  | 285 | 50 | 422 | 42.1 |
| 0329LFTV3000HP | 800            | 843  | 905  | 780  | 312 | 60 | 463 | 47.4 |
| 0329LFTV3200HP | 900            | 947  | 1005 | 884  | 345 | 60 | 507 | 53.3 |
| 0329LFTV4000HP | 1000           | 1050 | 1112 | 972  | 379 | 65 | 557 | 59.3 |
| 0329LFTV4800HP | 1200           | 1240 | 1320 | 1167 | 447 | 75 | 620 | 71.2 |

**PE 100**

# FLANGE ADAPTOR

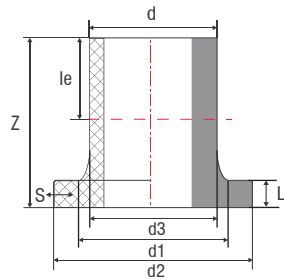
**SDR 11 - PN 16**

| PART #         | DIAMETER<br>Ød | d1  | d2  | d3  | le  | L  | Z   | S    |
|----------------|----------------|-----|-----|-----|-----|----|-----|------|
| 0329LFTV0200HP | 63             | 78  | 102 | -   | 88  | 14 | 120 | 3.8  |
| 0329LFTV0250HP | 75             | 92  | 122 | -   | 97  | 16 | 130 | 4.5  |
| 0329LFTV0300HP | 90             | 108 | 139 | -   | 106 | 17 | 140 | 5.4  |
| 0329LFTV0400HP | 110            | 125 | 158 | -   | 113 | 17 | 155 | 6.5  |
| 0329LFTV0450HP | 125            | 135 | 158 | -   | 120 | 20 | 160 | 7.4  |
| 0329LFTV0500HP | 140            | 155 | 188 | -   | 128 | 18 | 188 | 8.3  |
| 0329LFTV0600HP | 160            | 175 | 212 | 154 | 147 | 18 | 185 | 9.5  |
| 0329LFTV0700HP | 180            | 188 | 212 | 164 | 111 | 20 | 153 | 10.7 |
| 0329LFTV0800HP | 200            | 230 | 268 | 208 | 125 | 24 | 188 | 11.9 |
| 0329LFTV0900HP | 225            | 238 | 268 | 208 | 156 | 24 | 205 | 13.4 |
| 0329LFTV1000HP | 250            | 288 | 320 | 260 | 133 | 25 | 186 | 14.8 |
| 0329LFTV1100HP | 280            | 288 | 320 | 260 | 148 | 25 | 213 | 16.6 |
| 0329LFTV1200HP | 315            | 338 | 375 | 305 | 166 | 25 | 223 | 18.7 |
| 0329LFTV1400HP | 355            | 376 | 435 | 350 | 174 | 30 | 227 | 21.1 |
| 0329LFTV1600HP | 400            | 430 | 485 | 396 | 185 | 33 | 242 | 23.7 |
| 0329LFTV1800HP | 450            | 465 | 545 | 442 | 195 | 45 | 335 | 26.7 |

PE 100

## FLANGE

ELECTROGALVANIZED STEEL  
SDR 11 - PN 16

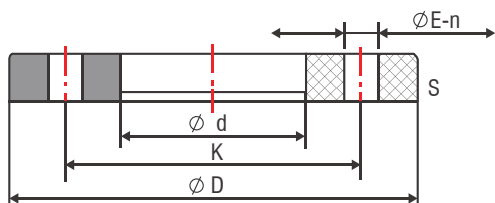

| PART #         | DIAMETER<br>Ød | S     |
|----------------|----------------|-------|
| 0329NFLV0150HP | 50             | 2.94  |
| 0329NFLV0200HP | 63             | 3.71  |
| 0329NFLV0250HP | 75             | 4.41  |
| 0329NFLV0300HP | 90             | 5.29  |
| 0329NFLV0400HP | 110            | 6.47  |
| 0329NFLV0450HP | 125            | 7.35  |
| 0329NFLV0500HP | 140            | 8.24  |
| 0329NFLV0600HP | 160            | 9.41  |
| 0329NFLV0700HP | 180            | 10.59 |
| 0329NFLV0800HP | 200            | 11.76 |
| 0329NFLV0900HP | 225            | 13.24 |
| 0329NFLV1000HP | 250            | 14.71 |
| 0329NFLV1100HP | 280            | 16.47 |
| 0329NFLV1200HP | 315            | 18.53 |
| 0329NFLV1400HP | 355            | 20.88 |
| 0329NFLV1600HP | 400            | 23.53 |
| 0329NFLV1800HP | 450            | 26.47 |
| 0329NFLV2000HP | 500            | 29.41 |
| 0329NFLV2200HP | 560            | 32.94 |



| PART #         | DIAMETER<br>Ød | L     |
|----------------|----------------|-------|
| 0329NFLV2400HP | 630            | 37.06 |
| 0329NFLV2800HP | 710            | 41.76 |
| 0329NFLV3400HP | 800            | 47.06 |
| 0329NFLV3600HP | 900            | 52.94 |
| 0329NFLV4000HP | 1000           | 58.82 |
| 0329NFLV4800HP | 1200           | 70.59 |



PE 100

## FLANGE

PP COATED STEEL  
PN 10/16

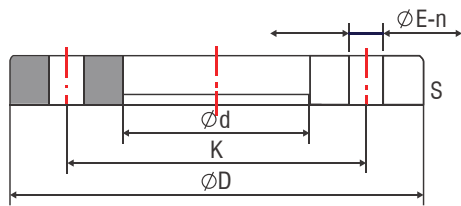

| PART #         | DIAMETER<br>Ød | S1   | S2    |
|----------------|----------------|------|-------|
| O329LFLV0150HP | 50             | 2.94 | 4.55  |
| O329LFLV0200HP | 63             | 3.71 | 5.73  |
| O329LFLV0250HP | 75             | 4.41 | 6.82  |
| O329LFLV0300HP | 90             | 5.29 | 8.18  |
| O329LFLV0400HP | 110            | 6.47 | 10.00 |

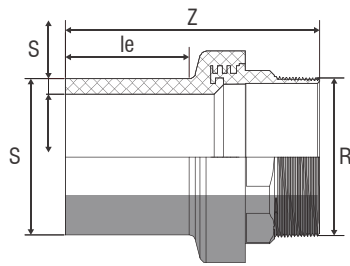
**PE 100**
**TRANSITION ADAPTOR**
**SDR 11 PE BRASS MALE THREAD  
WATER 16 BAR INJECTED -SPIGOT**

| PART #         | DIAMETER<br>Ød | Z   | Le | S    | WEIGHT(KG) |
|----------------|----------------|-----|----|------|------------|
| 0329NTAM0050HP | 20             | 90  | 41 | 3.0  | 0.084      |
| 0329NTAM0075HP | 25             | 84  | 41 | 3.0  | 0.104      |
| 0329NTAM0100HP | 32             | 103 | 44 | 3.0  | 0.208      |
| 0329NTAM0125HP | 40             | 122 | 49 | 3.7  | 0.310      |
| 0329NTAM0150HP | 50             | 121 | 55 | 4.6  | 0.398      |
| 0329NTAM0200HP | 63             | 140 | 63 | 5.8  | 0.578      |
| 0329NTAM0250HP | 75             | 146 | 70 | 6.8  | 0.982      |
| 0329NTAM0300HP | 90             | 168 | 79 | 8.2  | 1.380      |
| 0329NTAM0400HP | 110            | 179 | 82 | 10.0 | 2.030      |
| 0329NTAM0450HP | 125            | 186 | 87 | 11.4 | 2.226      |

## PE 100

### TRANSITION ADAPTOR

SDR 11 PE BRASS MS-58 FEMALE THREAD  
WATER 16 BAR INJECTED -SPIGOT

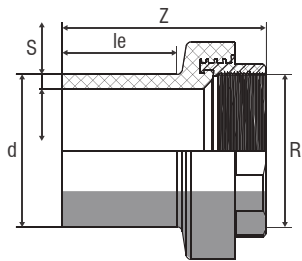

| PART #         | DIAMETER<br>Ød | Z   | Le | S    | WEIGHT(KG) |
|----------------|----------------|-----|----|------|------------|
| 0329NTAF0050HP | 20             | 72  | 41 | 3.0  | 0.058      |
| 0329NTAF0075HP | 25             | 72  | 41 | 3.0  | 0.072      |
| 0329NTAF0100HP | 32             | 84  | 44 | 3.0  | 0.152      |
| 0329NTAF0125HP | 40             | 98  | 49 | 3.7  | 0.318      |
| 0329NTAF0150HP | 50             | 101 | 55 | 4.6  | 0.304      |
| 0329NTAF0200HP | 63             | 115 | 63 | 5.8  | 0.386      |
| 0329NTAF0250HP | 75             | 129 | 70 | 6.8  | 0.828      |
| 0329NTAF0300HP | 90             | 144 | 79 | 8.2  | 1.122      |
| 0329NTAF0400HP | 110            | 147 | 82 | 10.0 | 1.732      |
| 0329NTAF0450HP | 125            | 153 | 87 | 11.4 | 1.806      |

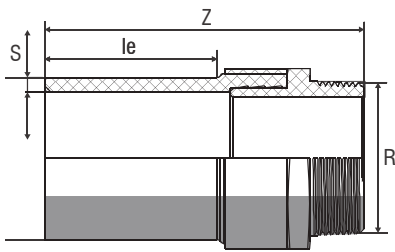
**PE 100**
**TRANSITION ADAPTOR**
**SDR 11 PE BRASS MS-58 MALE THREAD  
WATER 16 BAR INJECTED - LONG SPIGOT**

| PART #    | DIAMETER<br>Ød | Z   | Le | S   | WEIGHT(KG) |
|-----------|----------------|-----|----|-----|------------|
| 0329NE900 | 20             | 76  | 41 | 3.0 | 0.069      |
| 0329NE900 | 25             | 79  | 41 | 3.0 | 0.099      |
| 0329NE900 | 32             | 86  | 44 | 3.0 | 0.150      |
| 0329NE900 | 40             | 101 | 49 | 3.7 | 0.270      |
| 0329NE900 | 50             | 112 | 55 | 4.6 | 0.400      |
| 0329NE900 | 63             | 125 | 63 | 5.8 | 0.540      |

## HDPE 100

### TRANSITION ADAPTOR

SDR 11 PE BRASS MS-58 FEMALE THREAD  
WATER 16 BAR INJECTED - LONG SPIGOT

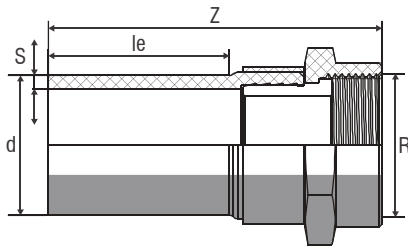

| PART #         | DIAMETER<br>Ød | Z   | Le | S   | WEIGHT(KG) |
|----------------|----------------|-----|----|-----|------------|
| 0329NTBM0050HP | 20             | 75  | 41 | 3.0 | 0.076      |
| 0329NTBM0075HP | 25             | 78  | 41 | 3.0 | 0.104      |
| 0329NTBM0100HP | 32             | 85  | 44 | 3.0 | 0.154      |
| 0329NTBM0125HP | 40             | 100 | 49 | 3.7 | 0.270      |
| 0329NTBM0150HP | 50             | 111 | 55 | 4.6 | 0.380      |
| 0329NTBM0200HP | 63             | 124 | 63 | 5.8 | 0.540      |

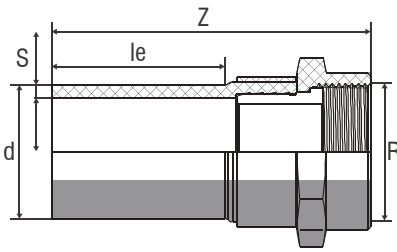
**HDPE 100**
**TRANSITION ADAPTOR**
**SDR 11 PE BRASS MS-58 LOOSE NUT  
WATER 16 BAR INJECTED - LONG SPIGOT**

| PART #         | DIAMETER<br>Ød | Z   | Le | S   | WEIGHT(KG) |
|----------------|----------------|-----|----|-----|------------|
| 0329NTBF0050HP | 20             | 78  | 41 | 3.0 | 0.086      |
| 0329NTBF0075HP | 25             | 77  | 41 | 3.0 | 0.113      |
| 0329NTBF0100HP | 32             | 85  | 44 | 3.0 | 0.184      |
| 0329NTBF0125HP | 40             | 97  | 49 | 3.7 | 0.289      |
| 0329NTBF0150HP | 50             | 112 | 55 | 4.6 | 0.452      |
| 0329NTBF0200HP | 63             | 122 | 63 | 5.8 | 0.660      |

## HDPE 100

### TRANSITION ADAPTOR

STEEL PIPE GR-B API SL EN-10208-1, MS -58  
EPOXY OR PE COATED FOR CORROSION  
RESISTANCE GR / WELD END LONG SPIGOT

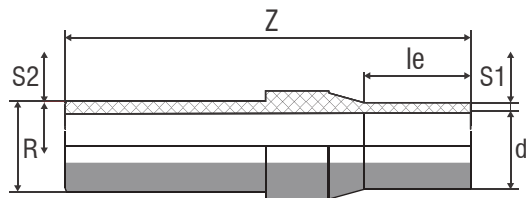

| PART #         | DIAMETER<br>Ød | Z   | Le  | S1   | S2  | WEIGHT(KG) |
|----------------|----------------|-----|-----|------|-----|------------|
| 0329NTAS0075HP | 25             | 43  | 43  | 3.0  | 2.9 | 0.650      |
| 0329NTAS0100HP | 32             | 100 | 100 | 3.0  | 3.4 | 0.950      |
| 0329NTAS0125HP | 40             | 57  | 57  | 3.7  | 3.6 | 1.310      |
| 0329NTAS0150HP | 50             | 62  | 62  | 4.6  | 3.7 | 1.570      |
| 0329NTAS0200HP | 63             | 106 | 106 | 5.8  | 3.9 | 2.450      |
| 0329NTAS0250HP | 75             | 70  | 70  | 6.8  | 5.2 | 3.710      |
| 0329NTAS0300HP | 90             | 83  | 83  | 8.2  | 5.5 | 5.110      |
| 0329NTAS0400HP | 110            | 156 | 156 | 10.0 | 6.0 | 7.7610     |
| 0329NTAS0450HP | 125            | 92  | 92  | 11.4 | 6.0 | 7.670      |
| 0329NTAS0500HP | 140            | 170 | 170 | 11.4 | 7.1 | 14.900     |
| 0329NTAS0600HP | 160            | 110 | 110 | 14.6 | 7.1 | 14.744     |
| 0329NTAS0700HP | 180            | 110 | 110 | 16.4 | 7.1 | 15.480     |
| 0329NTAS0800HP | 200            | 112 | 112 | 18.2 | 8.2 | 44.510     |
| 0329NTAS0900HP | 225            | 120 | 120 | 20.5 | 8.2 | 44.840     |
| 0329NTAS1000HP | 250            | 129 | 129 | 22.7 | 9.3 | 71.890     |
| 0329NTAS1100HP | 280            | 139 | 139 | 25.4 | 9.3 | 72.080     |
| 0329NTAS1200HP | 315            | 150 | 150 | 28.6 | 9.5 | 106.370    |



 /hydroplast-fittings

 hydroplast

 /hydroplast

 info@hydroplast.pk

[WWW.HYDROPLAST.PK](http://WWW.HYDROPLAST.PK)

**HDPE 100**  
**PE FITTINGS**